

**ITEM 60. TRAFFIC TREATMENT – ROAD CLOSURE – NEWCOMBE STREET
PADDINGTON**

TRIM RECORD NO: 2015/455176

RECOMMENDATION

It is recommended that the Committee endorse the following traffic treatments:

- (A) The closure of Newcombe Street (south), Paddington between Gordon Street and a new cul-de-sac just south of the private lane;
- (B) The reopening of Newcombe Street (north), Paddington to traffic, between the private lane and Oxford Street;

It is recommended that the Committee endorse the following allocation of parking:

- (C) Eastern side of Newcombe Street between the points 9.85 metres and 21.9 metres (three car spaces) as “2P 8am-6pm Mon-Fri” and “4P 6pm-10pm Mon-Fri, 8am-10pm Sat, Sun and Public Holidays”;
- (D) Eastern side of Newcombe Street between the points 21.9 metres and 28.6 metres (one car space), south of Oxford Street as “Loading Zone 8am-6pm Mon-Fri” and “4P 6pm-10pm Mon-Fri, 8am-10pm Sat, Sun and Public Holidays”;
- (E) Northern side of Gordon Street between the points -3.8 metres and 14.5 metres (three car spaces), east of Newcombe Street as “1P 8am-10pm Permit Holders Excepted Area 13”; and
- (F) Northern side of Gordon Street between the points 14.5 metres and 22.3 metres (one car space), east of Newcombe Street as “Disabled Parking Only”;

DECISION

BACKGROUND

In 2012, the City gave conditional approval for a development at 1 Newcombe Street Paddington which includes residential apartments, retail premises and associated car parking. In response to residents’ concerns about increased traffic accessing this site from Gordon Street, Council endorsed a proposal to close the southern end of Newcombe Street and reopen the northern end at the intersection with Oxford Street.

COMMENTS

Newcombe Street runs between Oxford and Gordon Streets. The northern portion of Newcombe Street, where it connects with Oxford Street, was closed as a public road in the 1980s and is currently a paved plaza space. This space is adjacent to the Paddington Uniting Church, the location of the popular weekend Paddington markets. At the southern end, the street is currently a two way no-through road off Gordon Street and provides access a private laneway midblock.

The change in access arrangements in Newcombe Street provides the opportunity to renew the street. A new paved plaza with trees, planting and a larger grassed area will be created at the southern end. The northern end will become opened to Oxford Street, providing access to the development in Newcombe Street and the existing private laneway.

A proposal to reclassify the northern end of Newcombe Street, Paddington from 'Community Land' to 'Operational Land'" has been submitted to the Department of Planning and Infrastructure.

The process for the reclassification of the proposed closure of southern end of Newcombe Street under Section 34 of the Roads Act 1993, is expected to take over two years to complete. Therefore a closure for Newcombe Street under Section 116 of the Roads Act 1993 is required to permit the commencement of the project construction works.

Four existing car parking spaces from Newcombe Street (south) will be relocated to Gordon Street across the new Newcombe Street closure and include an accessible car parking space.

Four existing car parking spaces on Oxford Street will be relocated to the new section of Newcombe Street (north). One of these spaces will become a Loading Zone to service surrounding commercial premises, while the remaining spaces will be allocated as 2P/4P for visitors to Oxford Street.

On Paddington Market days, approximately 13 stall holders currently use the paved plaza space on the northern end of Newcombe Street. These stalls will be accommodated in the new paved area at the southern end of Newcombe Street.

The private laneway midblock along Newcombe Street is in use by commercial properties along Oxford Street that back onto the lane. The entry into this private laneway will become accessible from Oxford Street and will be paved at the entry to improve pedestrian priority along Newcombe Street at this location.

The Traffic Management Plan to permanently close Newcombe Street at the Gordon Street end has been approved in principle by the RMS. A Stage 2 Road Safety Audit has been carried out with all comments taken into consideration as part of the detail design.

CONSULTATION

The City consulted local residents and businesses in the area. There were 700 letters sent out. In addition, 3000 subscribers to the City's online consultation hub sydneyoursay.com.au were notified through an email newsletter. Consultation under Section 116 of the Roads Act 1993 has also been carried out.

In total 48 written submissions were received. A petition was also received containing 147 signatures expressing support for the changes to Newcombe Street.

From the 48 submissions received, 33 expressed varying levels of support and 12 were opposed. Three (3) submissions made suggestions or raised a concern without supporting or objecting to the proposal.

The proposal was very well supported; some concerns were raised over tree removal, pedestrian safety, disadvantage to market stall holders, lack of need for the proposal and disruption during construction. However these concerns were taken into consideration as part of the design development where possible.

All properties that use the unnamed private lane have been notified of the proposed construction works and program.

FINANCIAL

Funds are available in the current budget.

ATTACHMENTS

Traffic Treatment – Road Closure - Newcombe Street Paddington

Erin Johnston, Design Manager, City Projects and Property

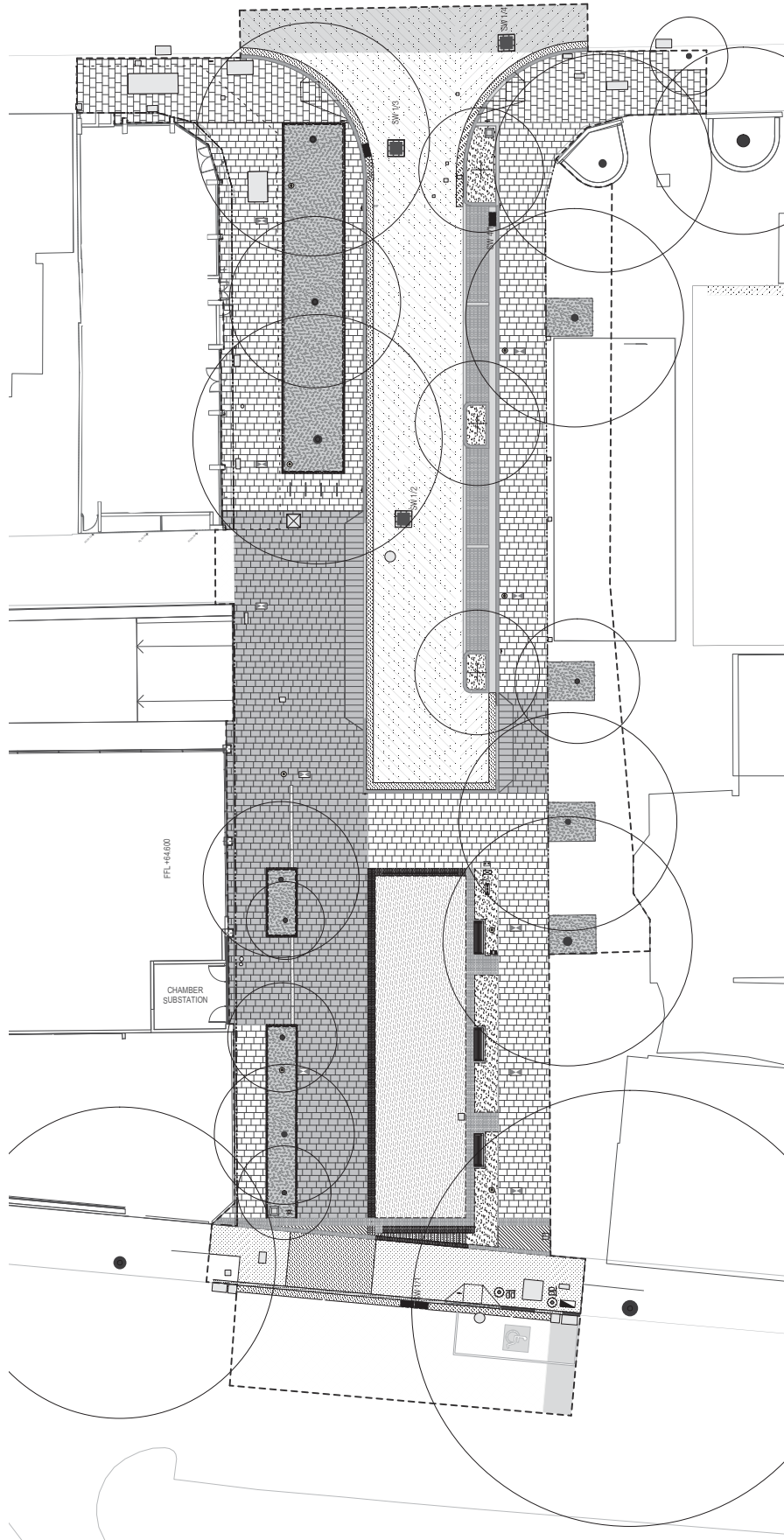

Sheet Title
FULL SITE

Sheet No.
LD_CD_XX

By

Date

Revision Log

Revision Revision Description



Scale & Orientation
1:150 @ A1



All dimensions are in millimetres unless otherwise noted. Do not scale from this drawing.

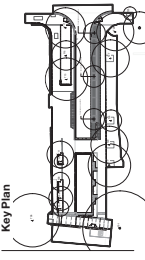

Key Plan

Newcombe Street

Project No. 3185L Paddington

Construction Documentation

Client
 City of Sydney



McGregor Coxall Pty Ltd, ACN 092 334 290
 Level 7/25 Pitt Rivers Lane,
 Melbourne VIC 3006
 Melbourne - 61 3 9999 1608
 Web: www.mcgregorcoxall.com

Rev

OXFORD STREET

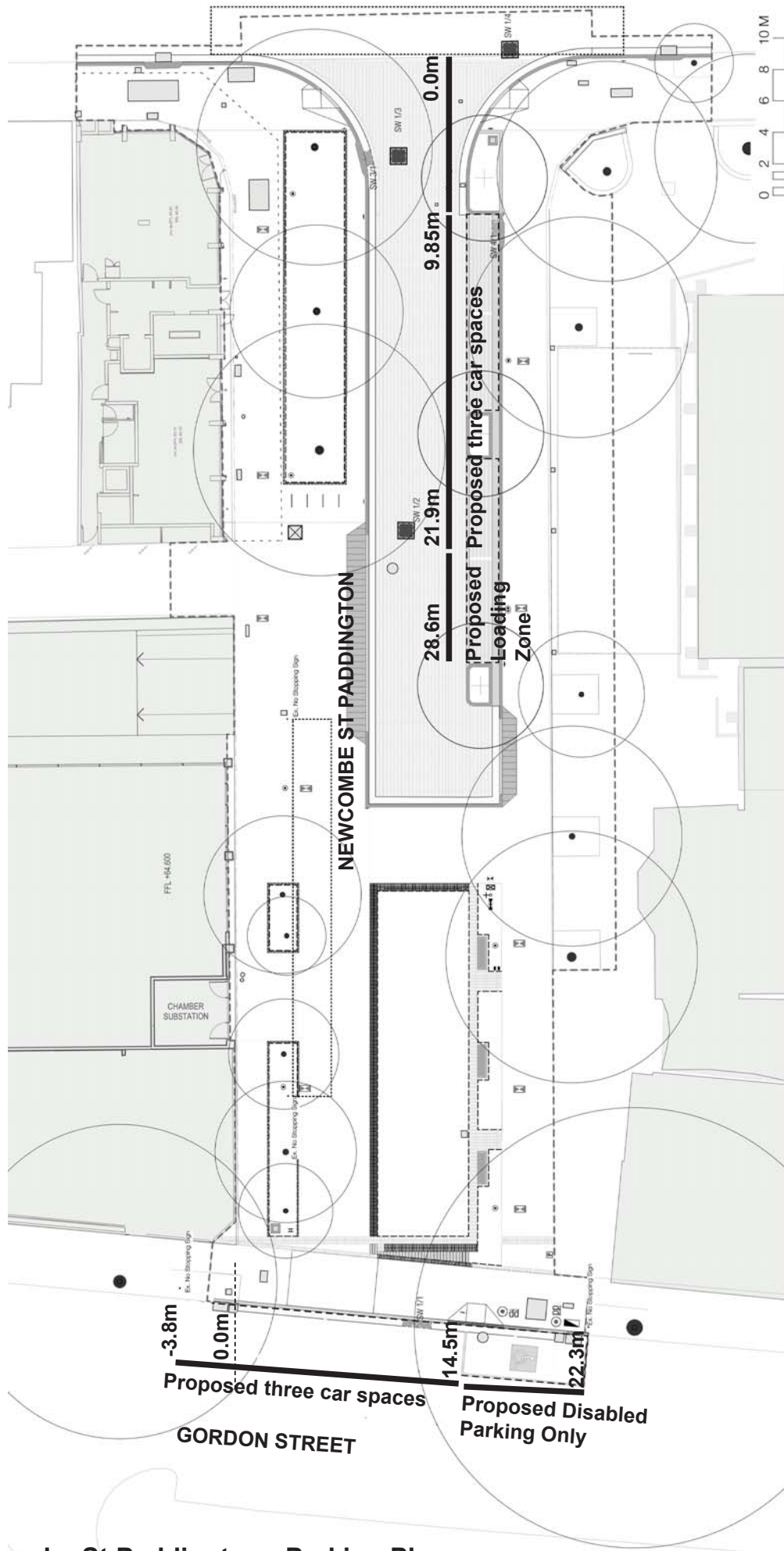

Newcombe St Paddington - Parking Plan

